

Operating Instruction

SR 900

Half mask



General information

Instructions for use for SR 900 should be read before use.

Together with filters from the Sundström filter range in accordance with EN 140:1998. Three sizes S, M and L.

Together with compressed air attachment SR 307, SR 507 and SR 358, SR 359 or SR 360 in accordance with EN 14594:2005, 3A

Together with powered air unit SR 500 or SR 700 in accordance with EN 12942:1998

Together with Remote filter holder SR 905 according to EN 12083.

When selecting equipment for SR 900 some of the factors that should be taken into account are as follows:

- Type of pollutant
- Concentrations
- Work intensity
- Protection requirements in addition to respiratory protective advice.

Risk analysis should be carried by a person who has suitable training and experience in the area.

Unpacking SR 900



Packing list:

- Half mask
- Pre-filter
- Pre-filter holder
- Cleaning tissue
- ID-tag
- User instructions
- Storage bag

1. Filter



1.1 Check that you have selected the right filter and that the use-by date has not been passed. (Specified on the filter and is valid provided that the filter packaging is unopened.)



1.2 In environments in which both gases and particles occur, such as in spray painting, gas and particle filters must be combined.



1.3 Place the particle filter on top of the cartridge. Grasp both protective elements. Squeeze hard until you hear the particle filter snap onto the gas filter.



1.4 Place a coin in the space between the lower lip of the particle filter and the small tab moulded into the side of the gas filter. Push firmly and twist the coin until the filter pops off.

1. Filter



1.5 Fit the filter in the mask so that the arrows on the filter point towards the user's face.

Check that the edge of the filter is sealed by the filter holder all around and that the filter is in the internal groove of the filter holder all around



1.6 Fit the pre-filter in the pre-filter.



1.7 Press it into place on the filter.

2. Donning



2.1 Remove any hood, glasses or ear protection from head.

Put the mask on.



2.2 Take out any twists or tangles. Adjust the harness.



2.3 Wiggle the respirator until it fits comfortably.

3. Adjusting the harness



3.1 Reach behind your neck and grab the free end of the harness strap.



3.2 Pull the free end away from the neck until buckle pops open.



3.3 Pull on the free end of the strap until the respirator seats comfortably on your face.

Use your thumb and forefinger to squeeze the buckle shut.



3.4 Wiggle the respirator until it seats comfortably.

4. Fit check



4.1 Put the mask on.

If any leakage is detected:

- check the exhalation membranes, exhalation valves and the gasket,
- adjust the straps of head harness,
- switch to alternative size of the respirator.

Do not use the equipment if you cannot make the mask a tight fit during the fitting test.

Note that beard growth, scars, or other physical characteristics may interfere with a proper fit of the respirator.



4.2 Place the palm of your hand lightly over the hole on the pre-filter holder to make it tight. Take a deep breath and hold your breath for about 10s. If the mask is tight, it will be pressed against your face.

5. Change the exhalation membrane



5.1 Remove the protective cap.



5.3 Press the new membrane onto the pin. Carefully check that the membrane is in contact with the membrane seat all round.



5.2 Prise off the membranes.



5.4 Press the new protective cap into place.

6. Change the inhalation membrane 7. Change the head harness



6.1 Remove the membrane.



7.1 Detach the head harness from the mask.



6.2 Fasten the new membrane on the pin.



7.2 Attach the head harness to the mask.

8. Change filter holder



8.1 Detach the filter holder from the mask by turning it a $\frac{1}{4}$ of a turn.

8.2 Attach the new filter holder. Make sure the gasket is mounted correctly on the filter holder.

9. Change of gasket



9.1 Detach the filter holder from the mask by turning it a $\frac{1}{4}$ of a turn.



9.2 Release the gasket from the attachment on the filter holder. Mount the new gasket. Attach the filter holder.

10. Cleaning

Sundström cleaning tissues SR 5226 are recommended for daily care. If the mask is heavily soiled, use a warm (up to +40 °C), mild soap solution and a soft brush, followed by rinsing with clean water and drying in air at room temperature. If necessary, spray the mask with 70 % ethanol or isopropanol solution for disinfection.

NOTE! Never use solvents for cleaning.



10.1 Remove the filter, the covers for the exhalation valves, the membranes, the inhalation membrane and the head harness. The harness can be washed but takes extra time to dry.



10.2 Inspect all parts and replace with new parts as necessary. Critical areas are the exhalation membranes and the membrane seats which must have clean and undamaged contact surfaces.

Maintenance schedule

	Before use	After use	Annually
Visual check	•		
Fit check	•		
Cleaning		•	
Change membrane			•
Change harness			•
Change gasket			•
Change filter	See User instructions for filters		

Change parts

Always use genuine Sundström parts. Do not modify the equipment. The use of non-genuine parts or modification of the equipment may reduce the protective function and put at risk the approvals received by the product.

Product leaflet

Product	Model No.	Ordering No.
Half mask	SR 900 S, M, L	H01-3012, H01-3112, H01-3212

Product Description

The SR 900 half mask is made of thermoplastic elastomer (TPE) and polypropylene (PP) in three sizes, S, M and L. The mask is equipped with two exhalation valves, which ensures very low exhalation resistance. The valve covers with partitions effectively protect the exhalation membrane against dust and paint mist. The material and pigment of the mask body are approved by FDA for foods, which minimizes the risk of contact allergies.

The easily adjustable elastic head harness straps of the mask are designed as a V-shaped loop and have a large dished crown plate, which contributes towards a comfortable and safe fit.

The half mask SR 900 is used in combination with:

- Filters from the Sundström range.
- Remote filter holder SR 905 according EN 12083.
- The SR 307 or SR 507 compressed air attachmnet which then serves as a breathing apparatus with continuous flow for connection to a compressed air supply according EN 14594:2005.
- The fan unit SR 500/SR 700 and approved filters included in the Sundström fanassisted respiratory protective device system conforming to EN 12942:1998.

A pre-filter holder is supplied.

Best stored in box SR 230 or storage case SR 339.

Technical specification

	SR 900	EN 140:1998
Inhalation resistance at 30 l/min	≈ 3 Pa	≤ 50 Pa
Exhalation resistance at 160 l/min	≈ 70 Pa	≤ 300 Pa
Service temperature	-10 – +55 °C, < 90 % RH	-
Storage temperature	-20 – +40 °C, < 90 % RH	-
Weight	S = 132 g	-
	M = 136 g	-
	L = 138 g	-
Assigned Protection Factor ¹	20 (P3)	-
	10 (GasX)	-
	10 (GasX P3)	-
Nominal Protection Factor ²	48 (P3)	-
	50 (GasX)	-
	48 (GasX P3)	-
Approval	EN 140:1998	-

1) Specified in BS EN 529, and applies generally to all half masks with particle filters P3, regardless of the test results.

2) According to EN 529:2005.



Sundström Safety AB

Tel: +46 10 484 87 00
Västergatan 4
SE-341 50 Lagan

Sundström 
www.srsafety.com

- A. Mask body
- B. Gasket
- C. Filter holder
- D. Inhalation valve seat
- E. Exhalation valve seat
- F. Exhalation membrane
- G. Protective cap
- H. Inhalation membrane
- I. Head harness straps
- J. Filters (not included)
- K. Pre-filter
- L. Pre-filter holder
- M. Hose SR 951
- N. Twin hose SR 952
- O. Fan unit SR 500
- P. Fan unit SR 700
- Q. Remote filter holder SR 905
- R. Compressed air attachment SR 507
- S. Compressed air attachment SR 307

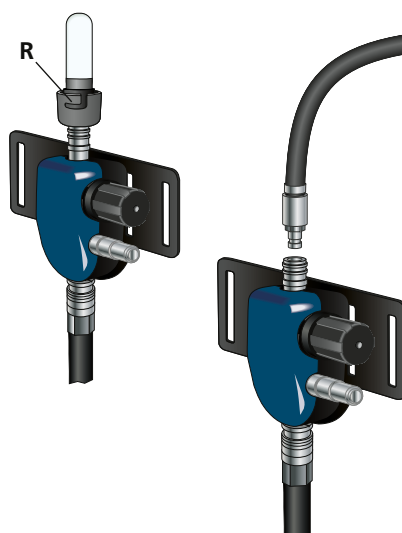
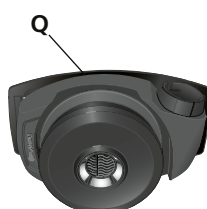
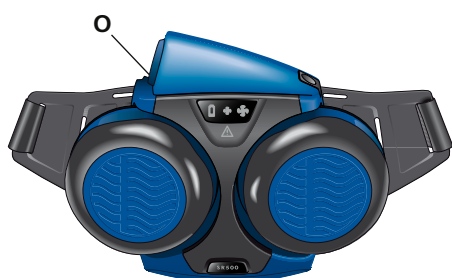
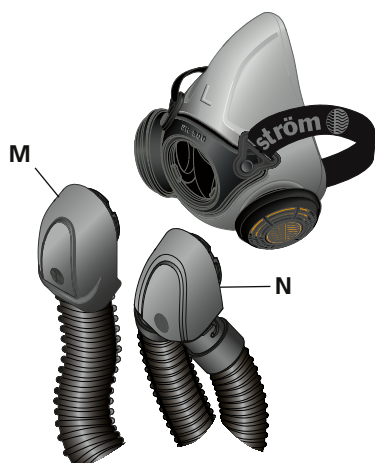
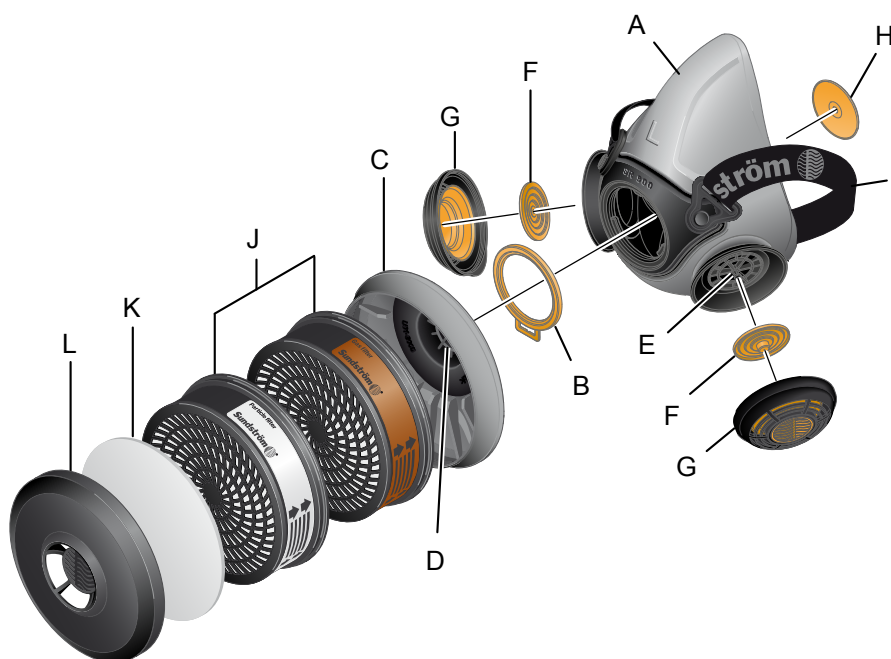

Spare parts / Accessories

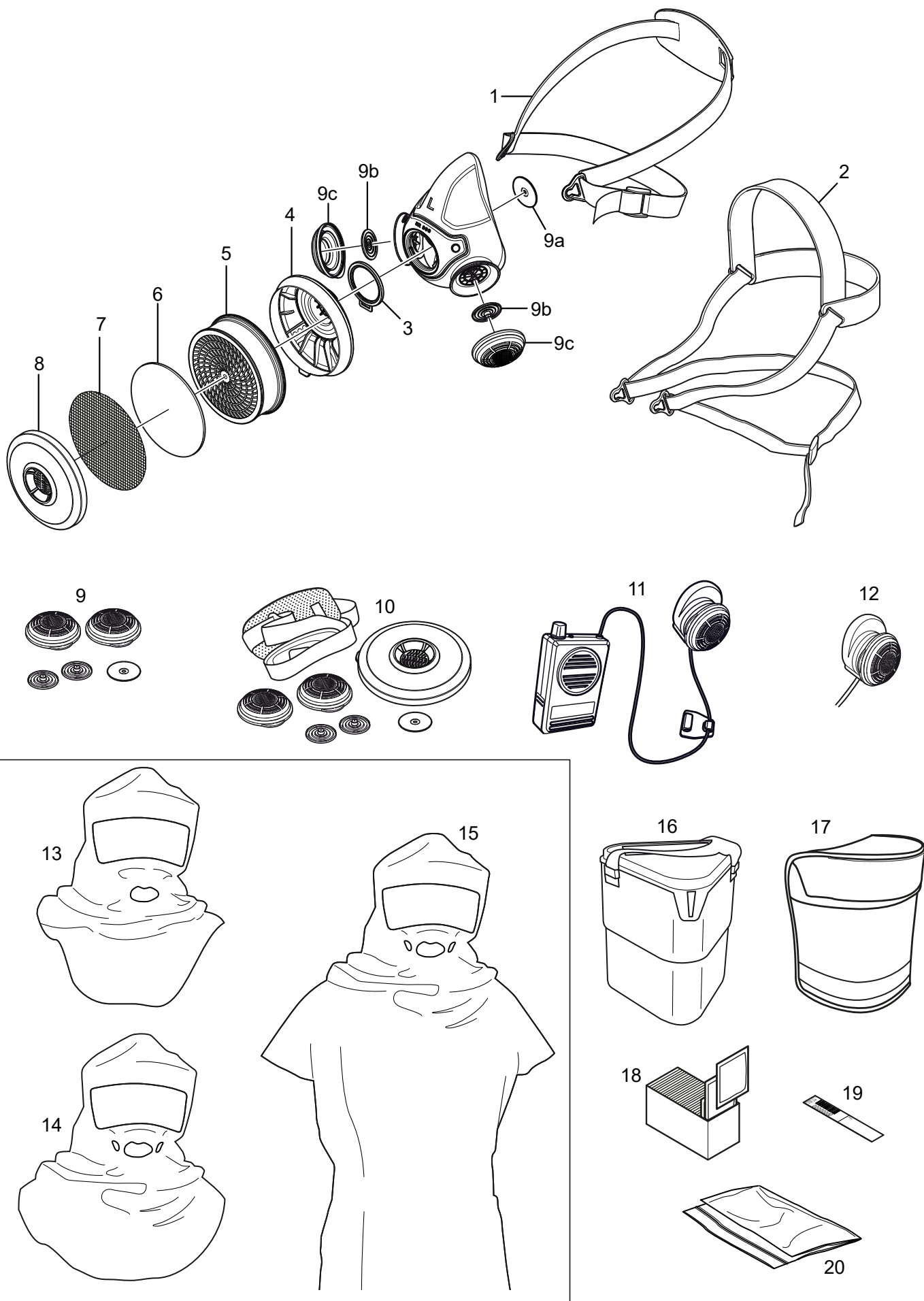

No.	Description	Ordering No.
1.	Head harness, single strap	R01-3001
2.	Head harness, cradle strap	R01-3002
3.	Gasket	R01-3004
4.	Filter holder	R01-3003
5.	Particle filter P3 R, SR 510	H02-1312
	Gas filter	
	A1, SR 217	H02-2512
	A2, SR 218	H02-2012
	A2AX, SR 298	H02-2412
	ABE1, SR 315	H02-3212
	A2B2E1, SR 294	H02-3312
	K1, SR 316	H02-4212
	K2, SR 295	H02-4312
	ABEK1, SR 297	H02-5312
	Combined filter ABEK1-Hg-P3 R, SR 299-2	H02-6512
6.	Pre-filter, SR 221	H02-0312
7.	Steel net disc	T01-2001
8.	Pre-filter holder	R01-0605
9.	Membrane kit SR 369	R01-2004
9a.	Inhalation membrane x1	-
9b.	Exhalation membrane x2	-
9c.	Protective cap x2	-
10.	Service kit	R01-3005
1.	Head harness	
9.	Membrane kit	
8.	Pre-filter holder	
11.	Small talk/Voice amplifier SR 324	T01-1217
12.	Test adapter SR 328	T01-1202
13.	Protective hood, Tyvek, SR 64	H09-0301
14.	Protective hood, PVC, SR 345	H09-1012
15.	Protective hood, PVC, SR 346	H09-1112
16.	Storage box SR 230	H09-3012
17.	Storage bag SR 339	H09-0112
18.	Cleaning tissue SR 5226. Box of 50	H09-0401
19.	ID-tag	R09-0101
20.	Plastic storage bag, 50pcs	R01-0607

SR 900-SYSTEM

SYSTEM OVERVIEW

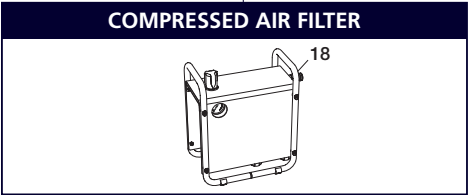
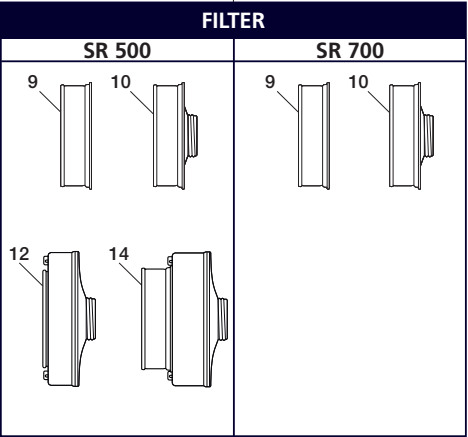
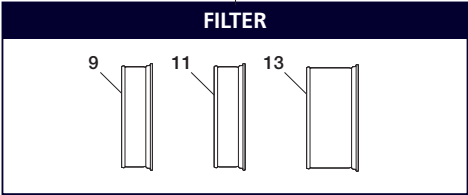
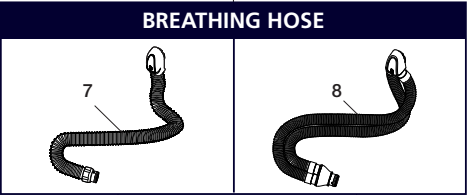
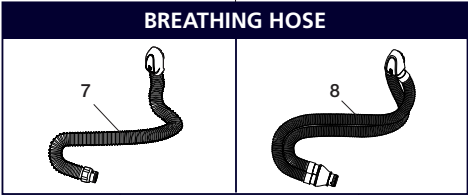
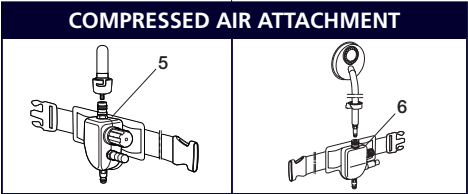
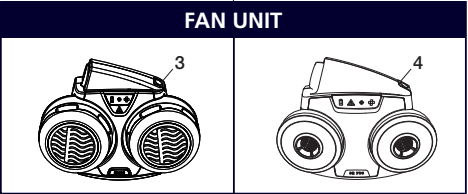
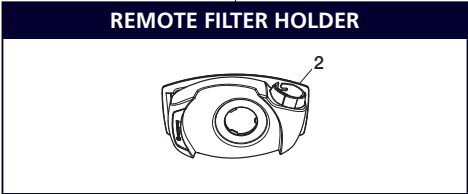
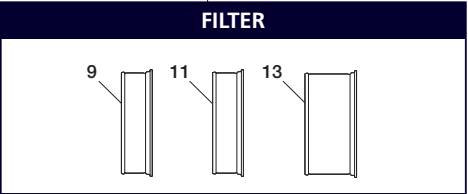

No.	Description	Model No.	Art No.
1.	Half mask	SR 900 S SR 900 M SR 900 L	H01-3012 H01-3112 H01-3212
2.	Remote filter holder	SR 905	T01-3002
3.	Fan unit	SR 500	H06-0112
4.	Fan unit	SR 700	H06-7010
5.	Compressed air attachment	SR 507	H03-0612
6.	Compressed air attachment	SR 307	H03-1412
7.	Hose	SR 951	T01-3003
8.	Twin hose	SR 952	R01-3009
9.	Particle filter P3 R	SR 510	H02-1312
10.	Particle filter P3 R	SR 710	H02-1512
11.	Gas filter A1 Gas filter A2 Gas filter A2AX Gas filter ABE1 Gas filter A2B2E1 Gas filter K1 Gas filter K2 Gas filter ABEK1	SR 217 SR 218 SR 298 SR 315 SR 294 SR 316 SR 295 SR 297	H02-2512 H02-2012 H02-2412 H02-3212 H02-3312 H02-4213 H02-4312 H02-5312
12.	Gas filter A2 Gas filter ABE1 Gas filter A1BE2K1	SR 518 SR 515 SR 597	H02-7012 H02-7112 H02-7212
13.	Combined filter ABEK1-Hg-P3 R	SR 299-2	H02-6512
14.	Combined filter A1BE2K1-Hg-P3 R	SR 599	H02-7312
15.	Hose	SR 360	H03-34XX
16.	Hose	SR 358	H03-30XX
17.	Hose	SR 359	H03-31XX
18.	Compressed air filter	SR 99-1	H03-2810